

ATTENTION UPMC MERCY SLEEP MEDICINE CENTER PATIENTS
Building A (MacLachlan), Level 4, Suite 4412
412-232-8625

****The wayfinding route starts from the Parking Garage****

If you are being dropped off for your appointment, please still go to the Parking Garage (and cross the foot bridge), **NOT** the main entrance of the hospital.

- The main entrance of the hospital closes at **8 p.m.**, therefore, you will be directed to enter through the foot bridge from the Parking Garage.

1. From the parking garage:
 - a) If being dropped off outside of the Parking Garage:
 - Go inside the Parking Garage and take the elevators to Level D (yellow level).
 - Exit the elevators and enter the hospital through the foot bridge.
 - b) If being dropped off inside of the Parking Garage:
 - Go directly to Level D and enter the foot bridge into the hospital.
 - Parking is free up to two hours; the driver may exit the parking garage for no fee and can insert the ticket directly into the station upon exit.

Detailed directions and maps are provided below.

Directions to UPMC Mercy Sleep Medicine Lab from the Parking Garage (Level 1):

- Take the **purple elevators** to **Level 2**

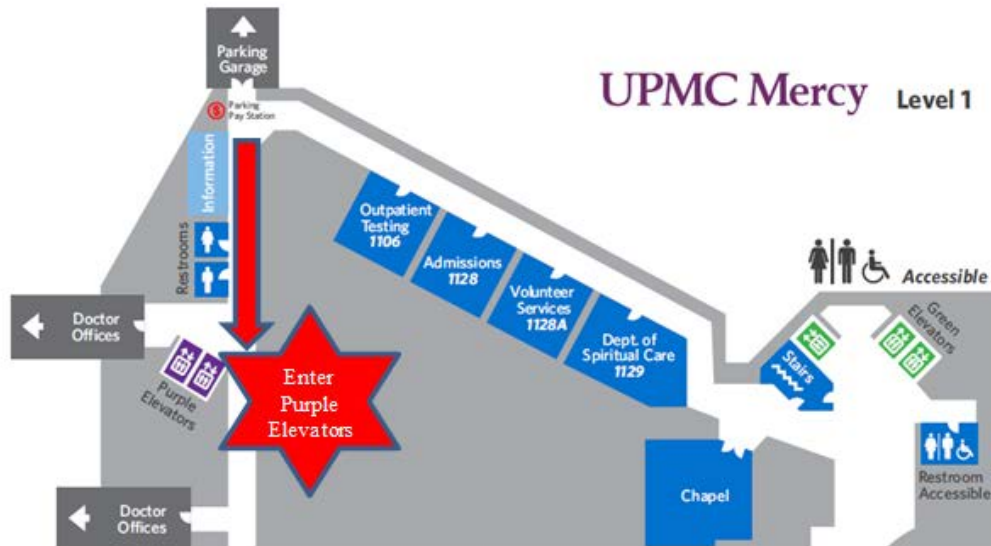

- Upon exit of the **purple elevators** on **Level 2**, turn right and proceed down the hallway and follow signs to the **yellow elevators**.
- Take the **yellow elevators** to **Level 4**. **Please note that the yellow elevators must be used to access the Sleep Medicine Lab as the purple elevators will not directly access this location.**

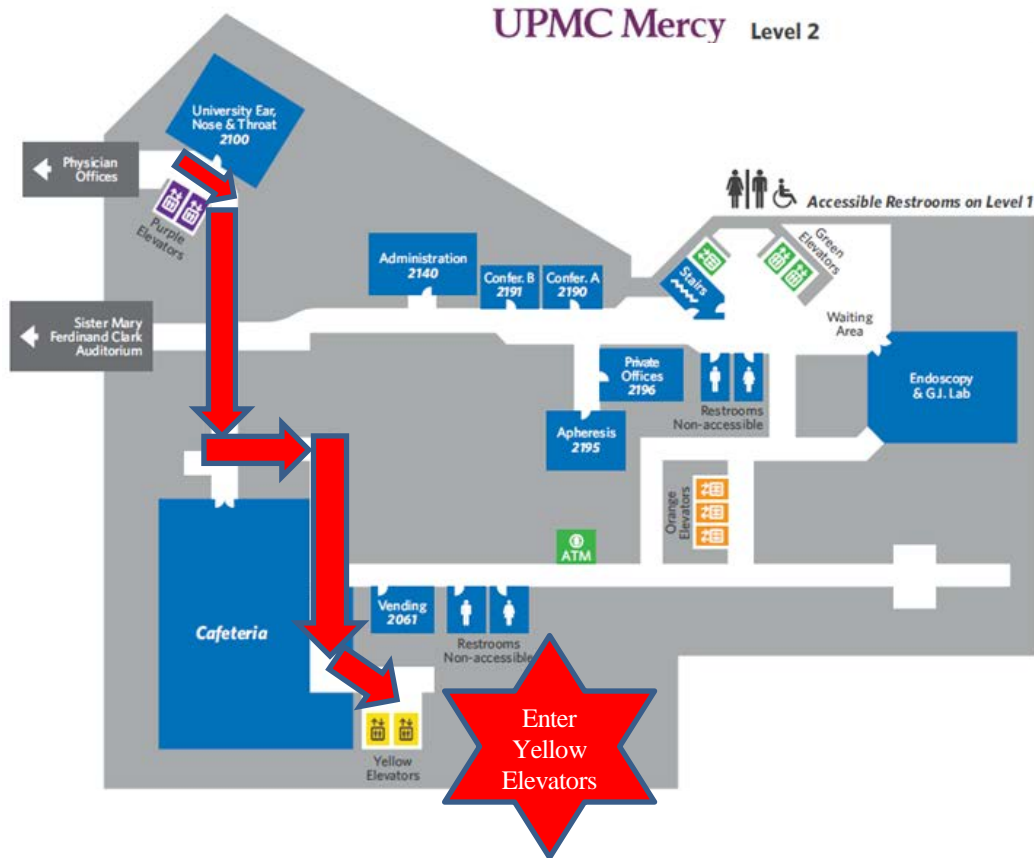

- Upon exit of the **yellow elevators** on **Level 4**, turn left and enter the Sleep Medicine Center.

